

T1 SUPER TARUS

THROTTLE BASE

User Manual

V 1.0 BETA

1	T1-BASE product introduction	1
1.1	1 Function introduction	2
1.2	Instructions for use	5
2	F18-TGRIP-L\F18-TGRIP-R	13
2.1	Switches and Button function introduction	13
3	F18-STARTUP(Side Panel) Product Introduction.....	14
3.1	Function introduction	14
3.2	Side panel Uninstall and install (factory installed)	16
4	T1-HOLDER	17
4.1	Desk mount adjustment instructions	17
5	Other installation methods (Official advice).....	21
5.1	Gaming chair installation	21
5.2	Cockpit installation.....	23

1 T1-BASE product introduction

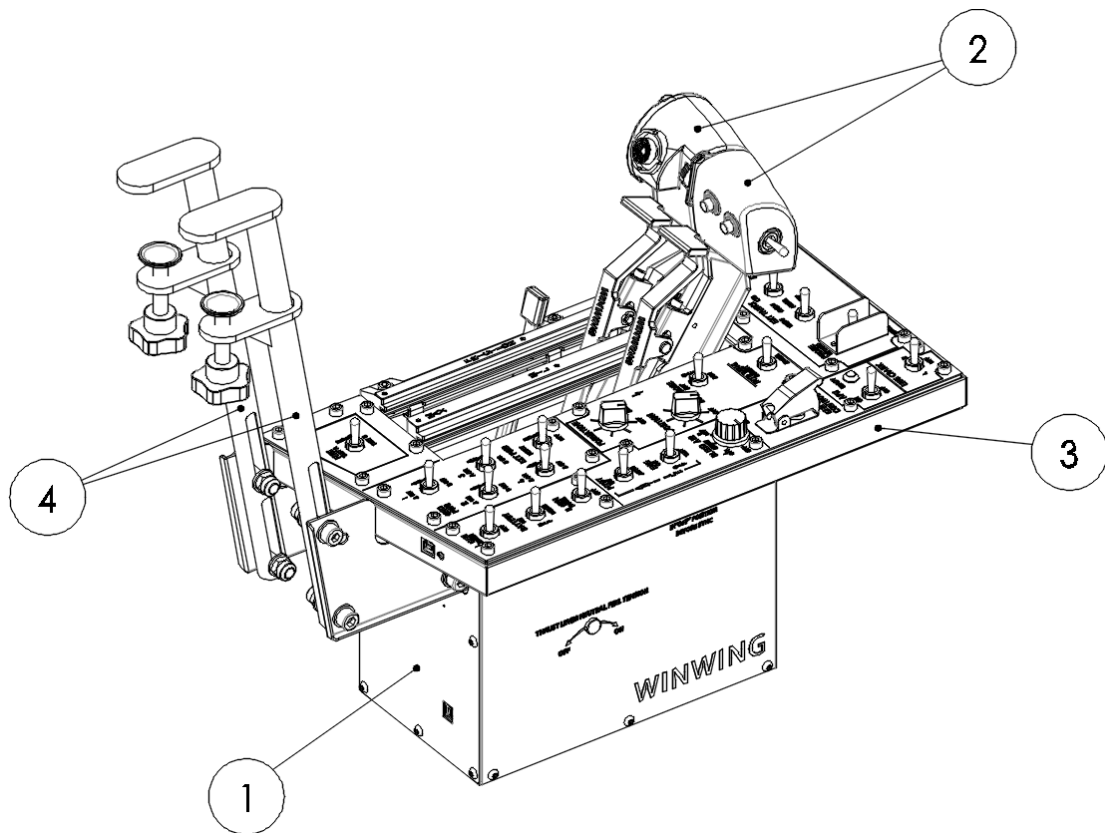

- ① Throttle Base (4kg)
- ② F18-TGRIP-L\F18-TGRIP-R Throttle Grips (1kg)
 - 4 of M4 10mm-type Allen screws.
 - To attach the changeable throttle grip.
- ③ F/A-18 Throttle Side Pane I (1.4kg)
- ④ Throttle Desk Mount Holder (1.5kg)
 - Includes Installation screws and Blocks
 - Install Info please see Throttle install page.

1.1 1 Function introduction

1.1.1 Functions of throttle

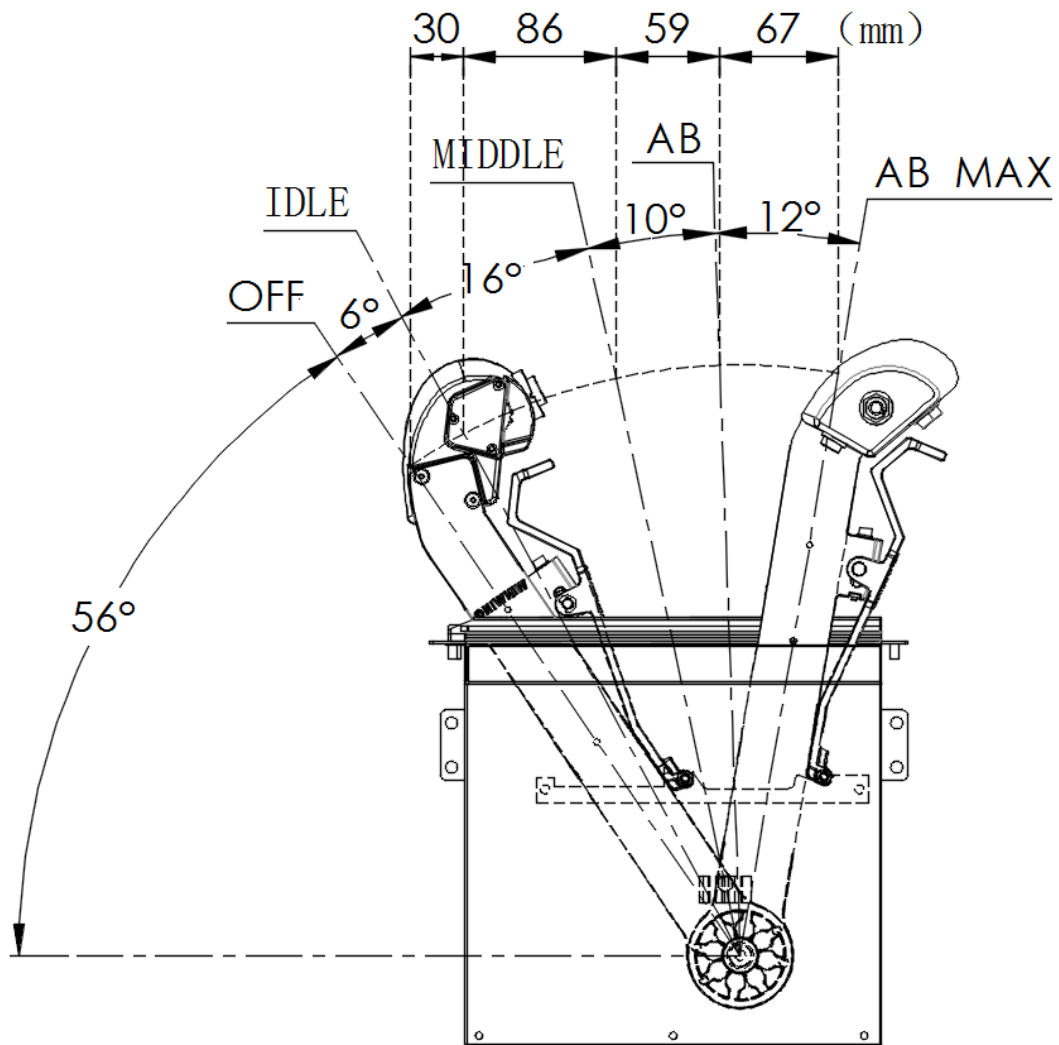

1. The minimum angle between the arm and the horizontal plane is 56°,The maximum angle is 100°.The total stroke angle of the arm is 44°.
2. The total distance of the head stroke exceeds 300mm.
3. MIDDLE gear is in the middle of the total stroke (22° angle to OFF).

4. Afterburner stroke range is 12°.

1.1.2 Other functions

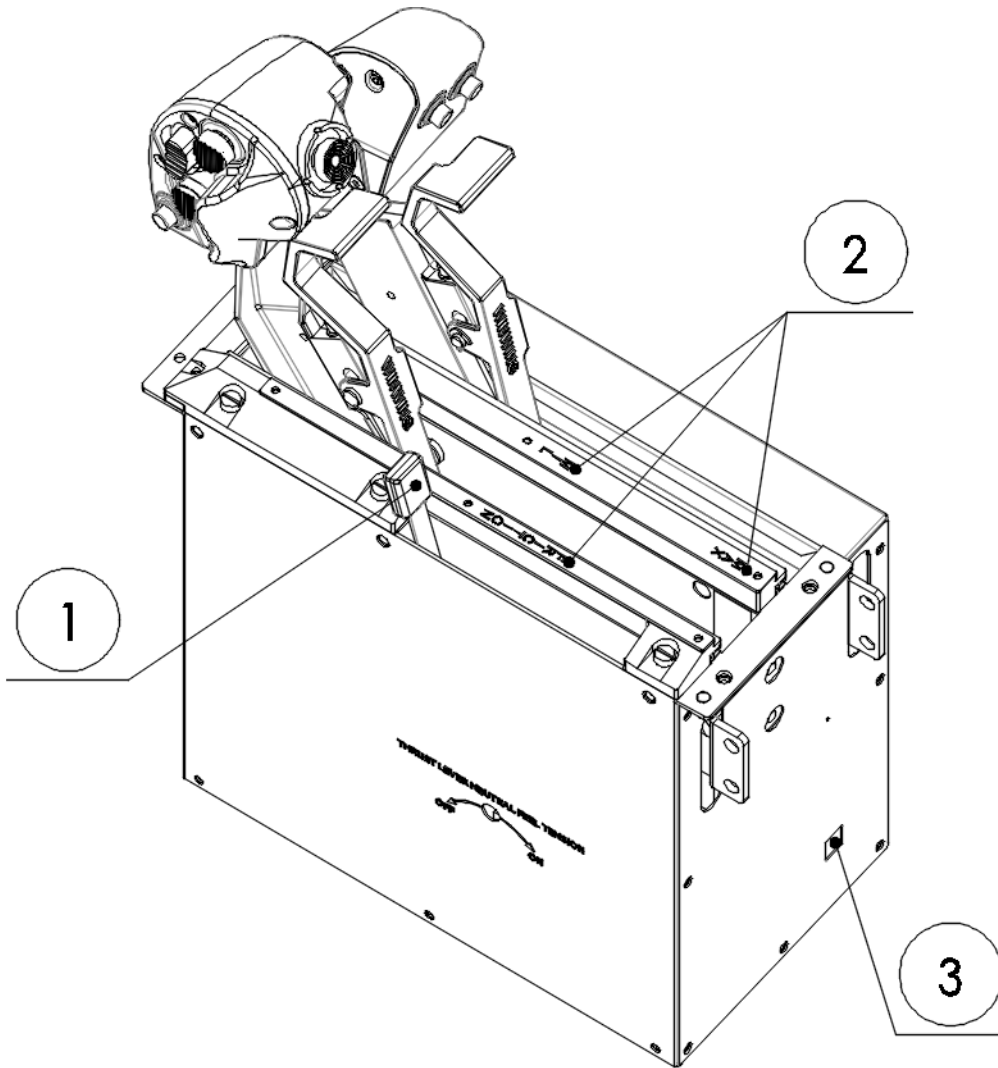

- ① Damping adjustment.
- ② Characters with backlight.
- ③ USB port.

1.1.3 Installation Template

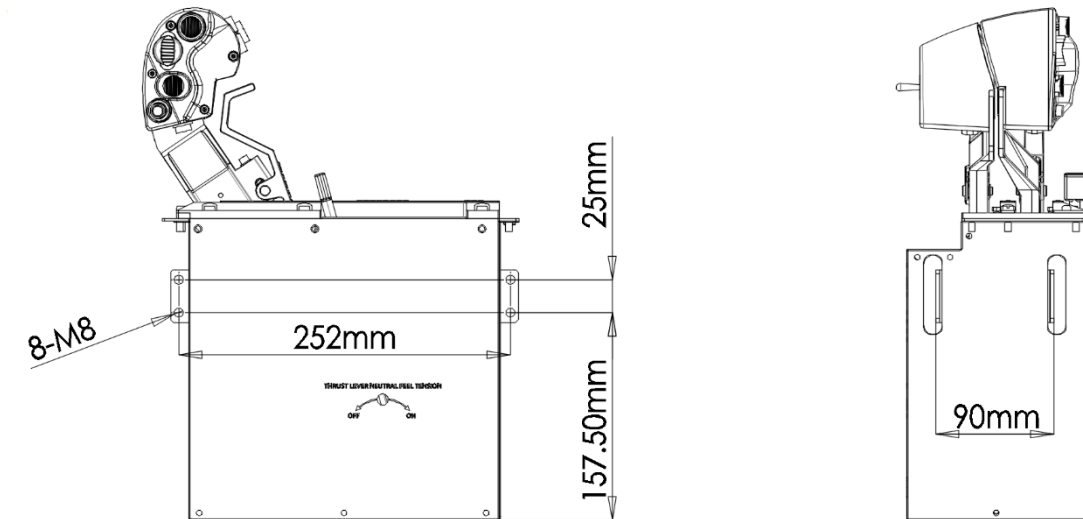

Mounting size as shown on picture.

- If you need Template. Click to (www.winwing.cn).

1.2 Instructions for use

1.2.1 Instructions of use for different gears

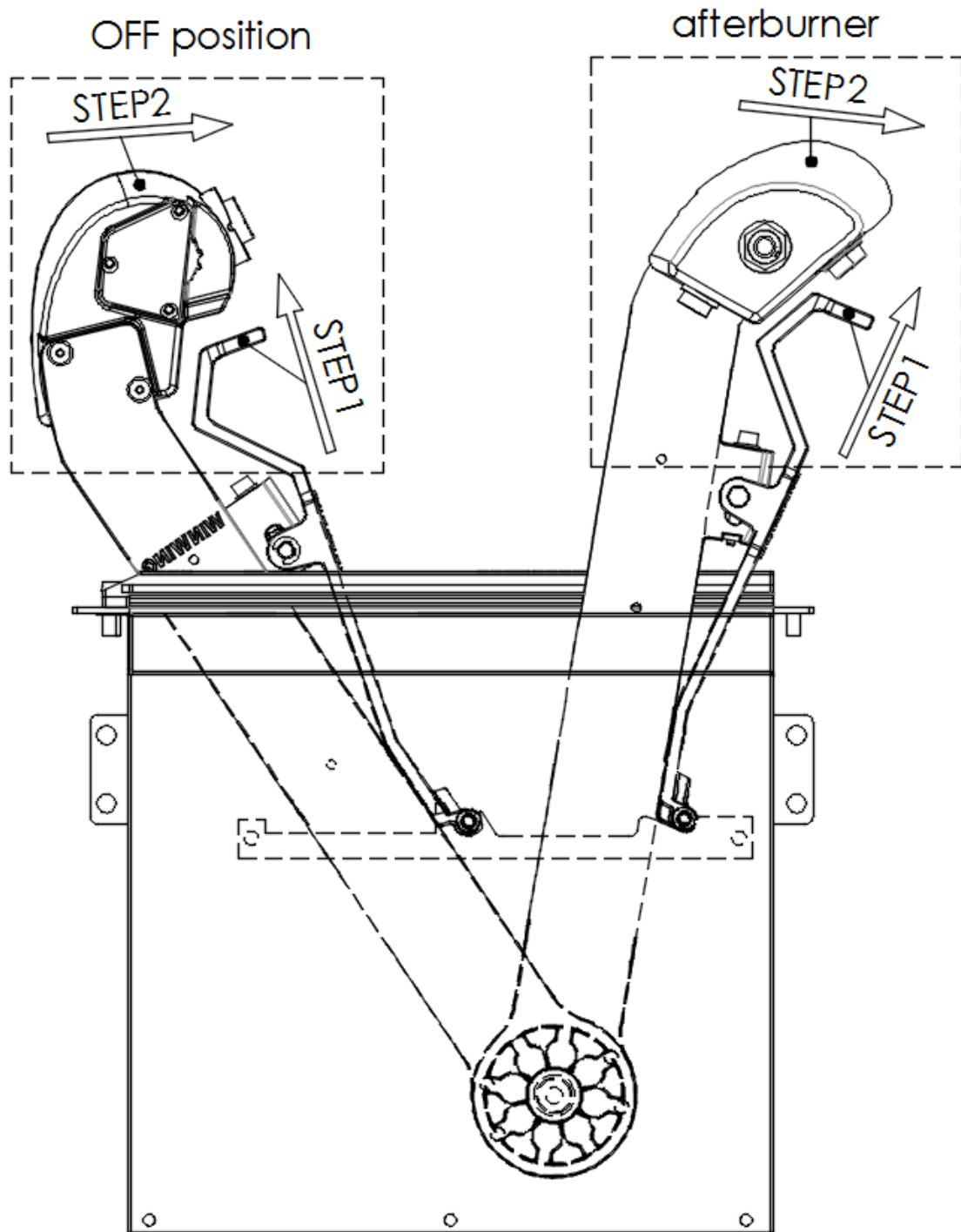

- When leaving and entering the OFF position, operate as shown on the figure.

STEP1 : Lift the lever up first;

STEP2 : Moving the Grip to target place.

- Enter the afterburner, there are two ways to operate.

The first type :

STEP1: Lift the lever up first;

STEP2: Push the grip forward.

The second type :

Go directly to the second step. Push the grip hard, and the lever will automatically unlock. (We prefer to use the first step of the operation.

This helps the product to last longer.)

1.2.2 Instructions of throttle grip sync

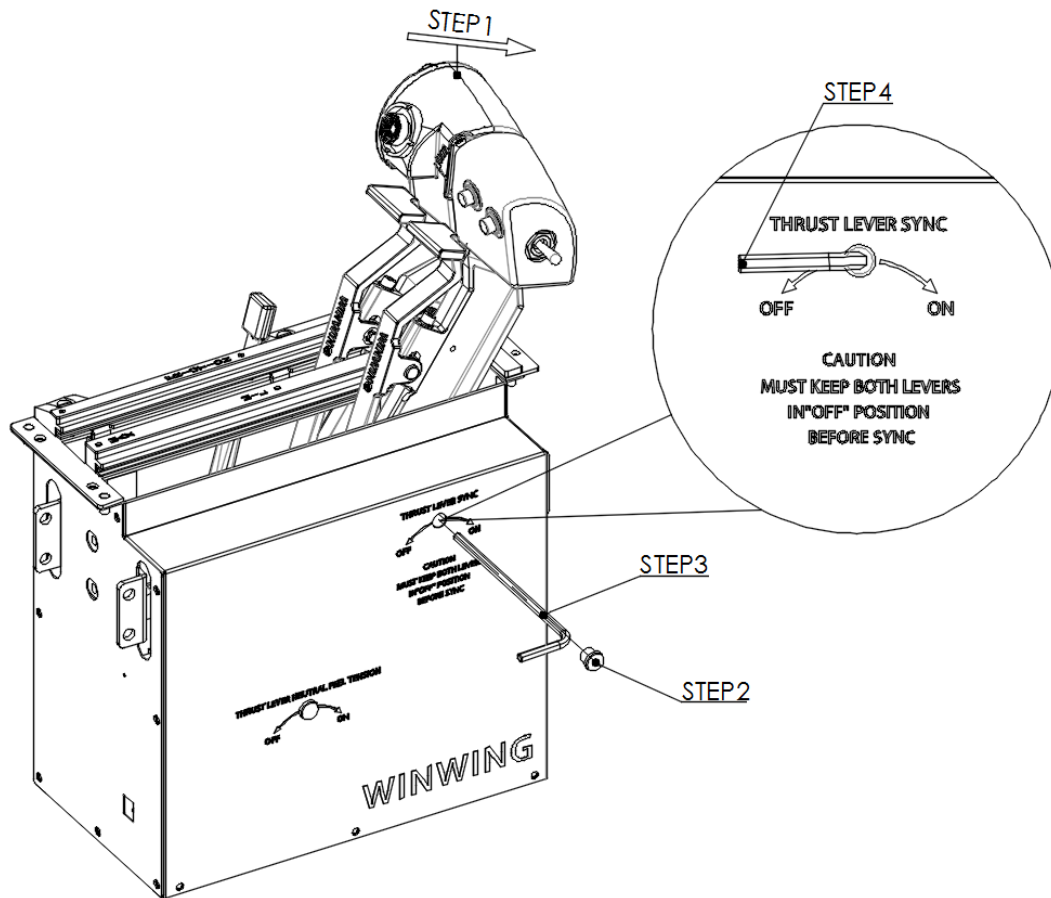

- The L / R throttle synchronization prompt structure can be turned on by mechanical adjustment.

STEP1 : Put the throttle arms in OFF.

STEP2 : Remove the dust plug of the adjustment port.

STEP3 : Insert Allen screw driver.

STEP4 : Rotating screwdriver adjustment.

Turn the screwdriver counterclockwise until it can't rotate. This will cause the sync structure to OFF ;Turn the screwdriver clockwise, every 1/2 turn, then try to synchronize whether the structure is ON.

If the function is not turned on, continue to rotate the screwdriver.

- Please don't rotate too many turns at a time. This will damage the device.

1.2.3 Instructions of MIDDLE dent on/off

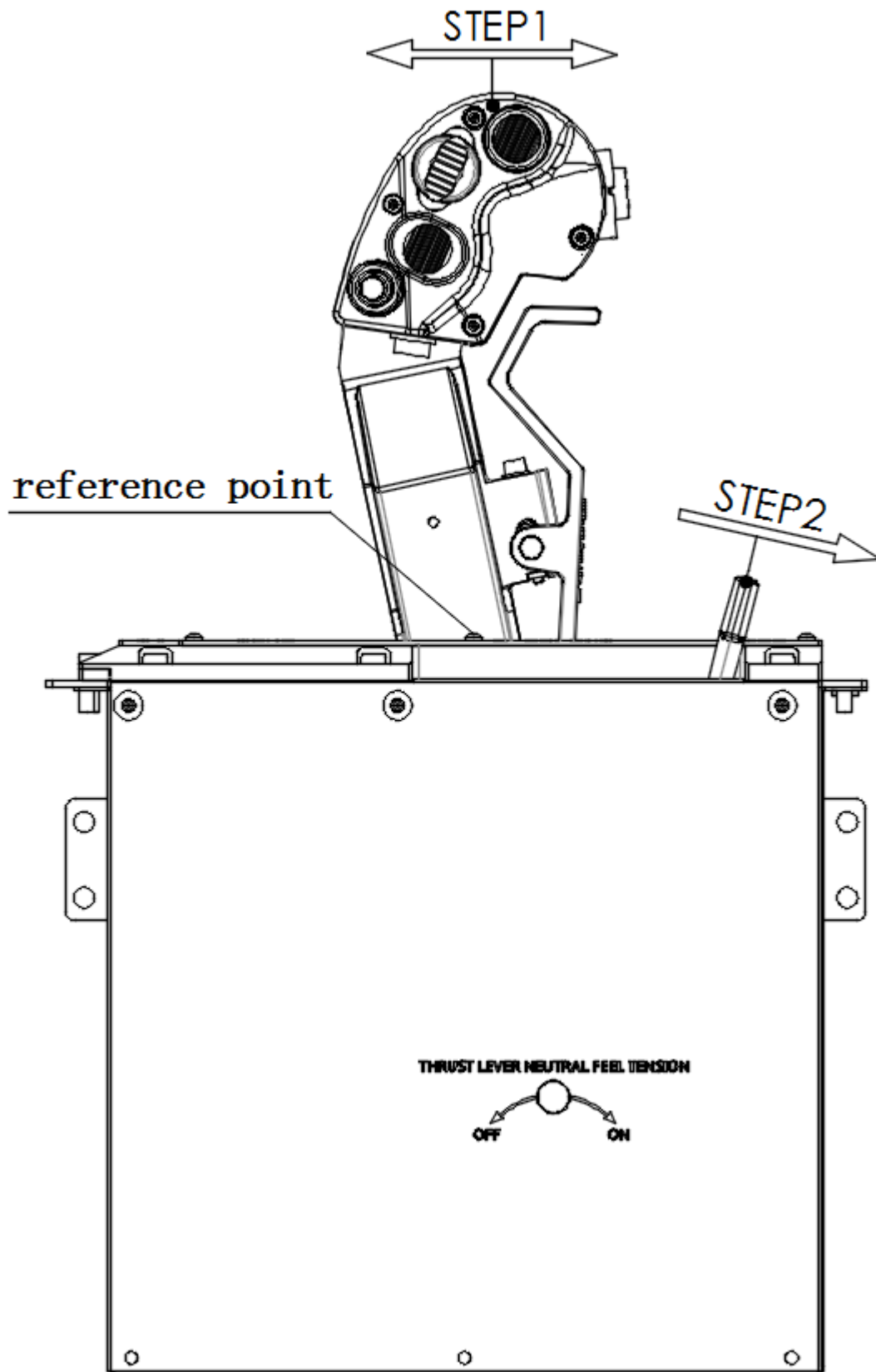

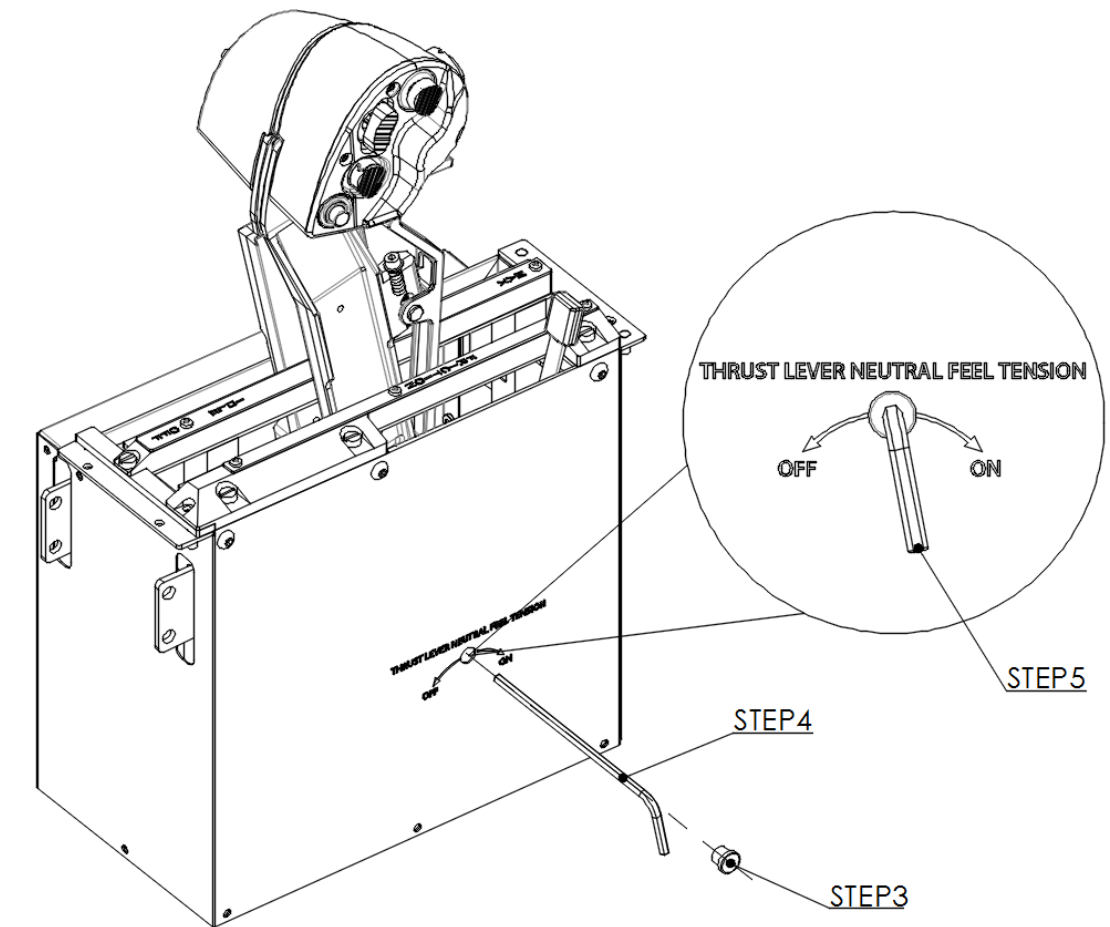

- MIDDLE scale adjustment (MIDDLE scale will bring additional resistance)

STEP1 : Move the L/R throttle to the position shown in the figure. The screw indicated in the figure can be used as a reference point.

STEP2 : Turn the resistance lever to the maximum position.

STEP3 : Remove the dust plug of the adjustment port.

STEP4 : Insert Allen screw driver.

STEP5 : Rotating screwdriver adjustment.

Turn the screwdriver counterclockwise until it can't rotate, it means MIDDLE dent is OFF.

Turn the screwdriver clockwise, every 1/2 turn, then try to MIDDLE dent is ON.

If the function is not turned on, continue to rotate the screwdriver.

The left and right adjustments are the same.

- Please don't rotate too many turns at a time. This will damage the device.

1.2.4 Instructions of Resistance adjustment

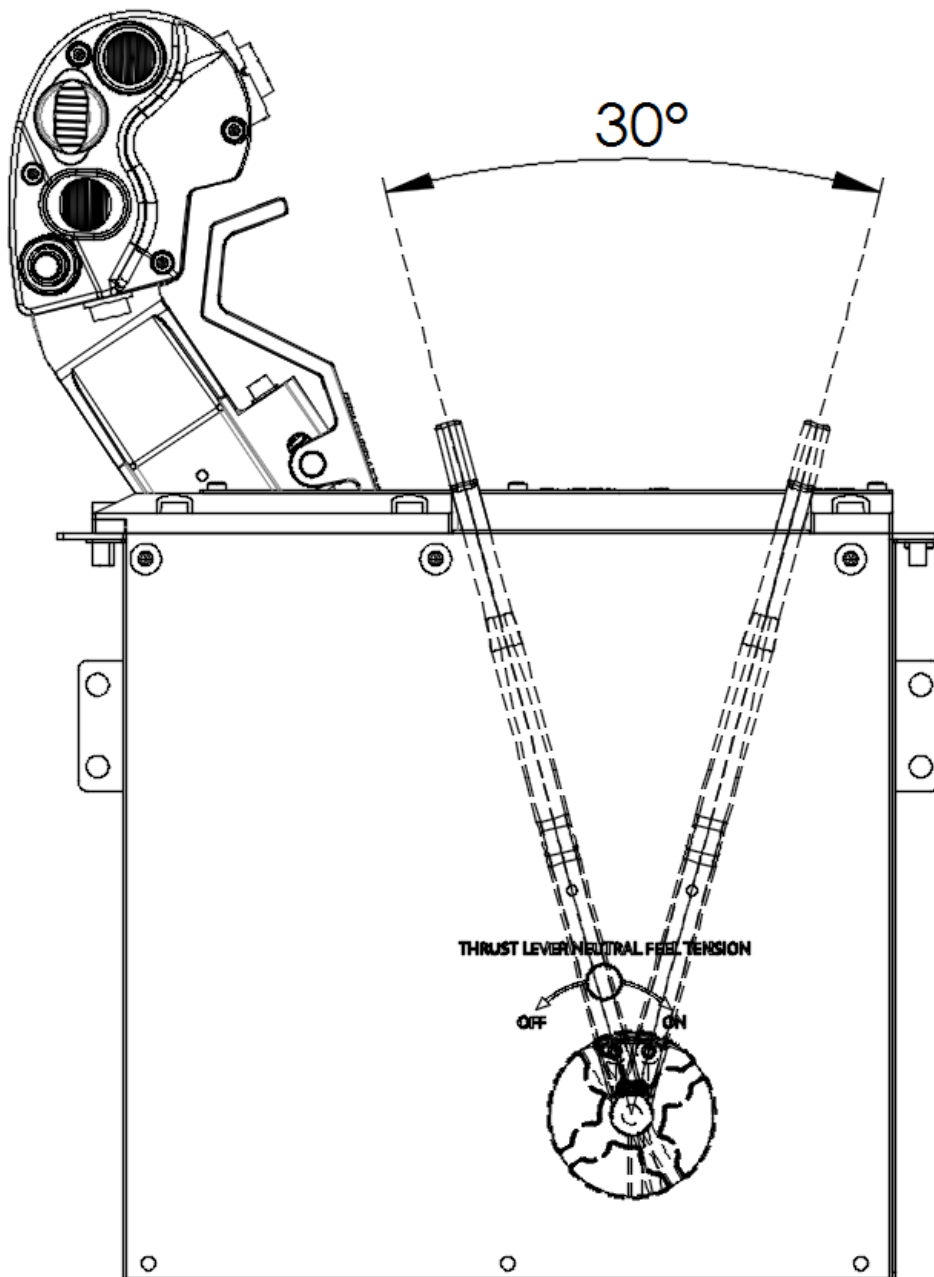

Resistance handle adjustable angle range is 30°.

We recommend adjusting the resistance according to your personal habits to get the best operating experience.

2 F18-TGRIP-L\F18-TGRIP-R

2.1 Switches and Button function introduction

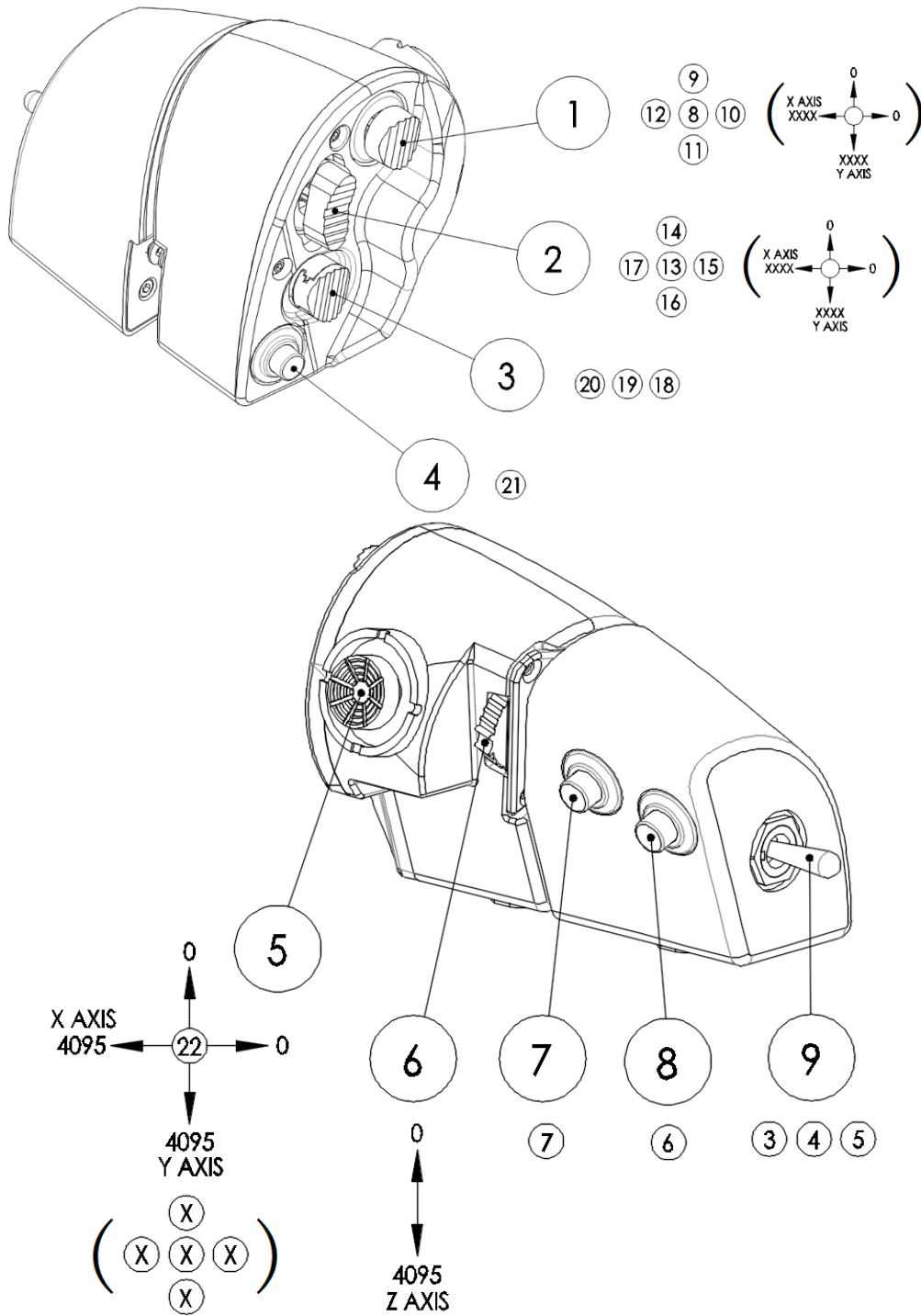

3 F18-STARTUP(Side Panel) Product Introduction

3.1 Function introduction

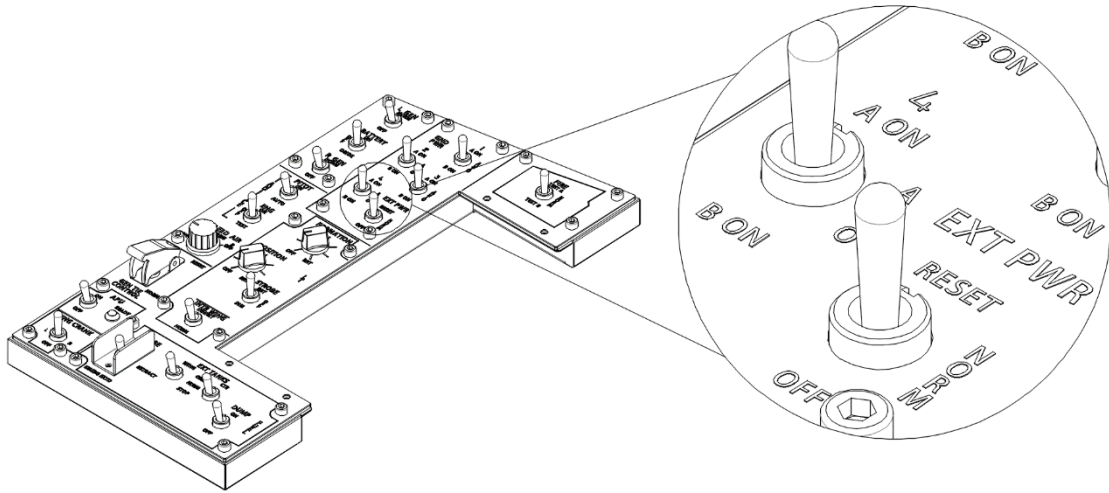

1. All characters on the panel are backlit.
2. All backlight brightness is adjustable.
3. All switches come with an add function that can be set via our software.

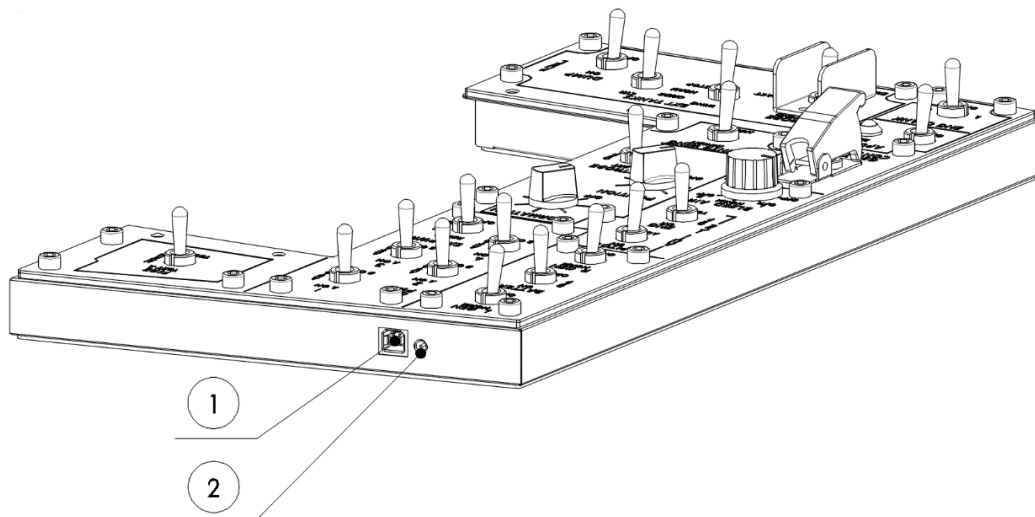

① USB port

② Power port (Back up)

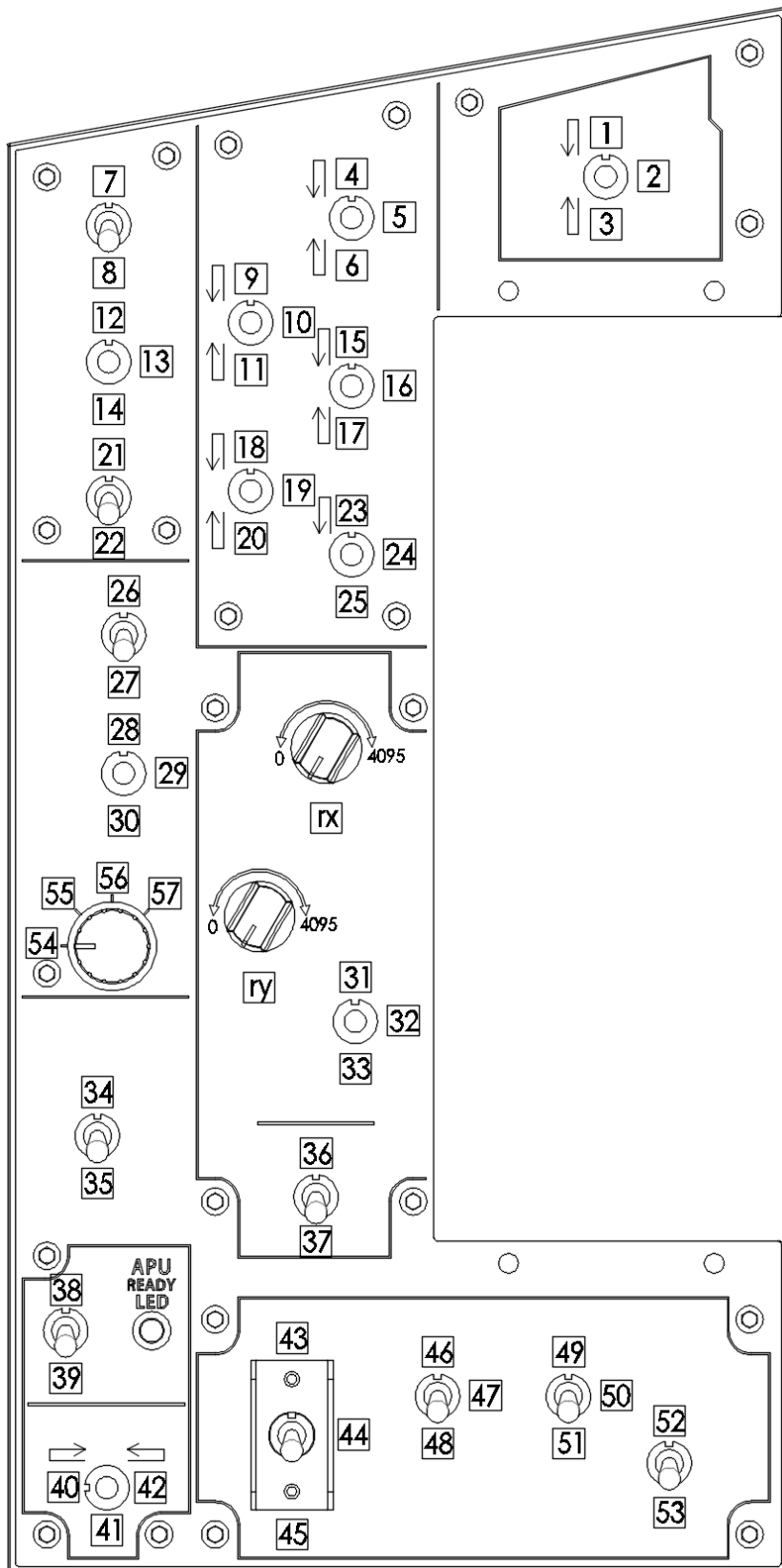

3.2 Side panel Uninstall and install (factory installed)

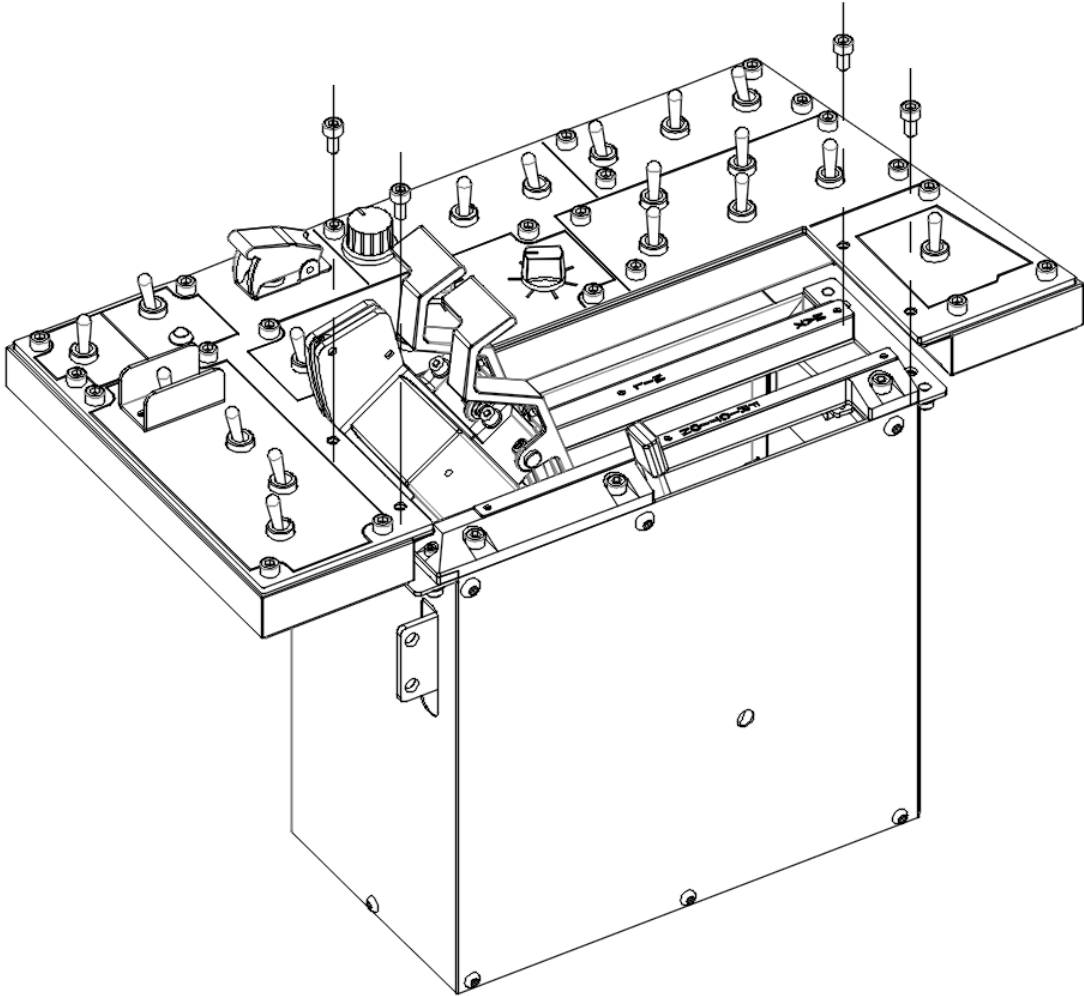

Install or remove the throttle side panel by installing or removing the 4 screws shown in the figure.

4 T1-HOLDER

4.1 Desk mount adjustment instructions

The total thickness limits of the table and the block mat is 30mm to 70mm. Our block mat size is: 50mm*40mm*30mm.

You can rotate the block mat according to the actual needs to achieve different thickness of the block.

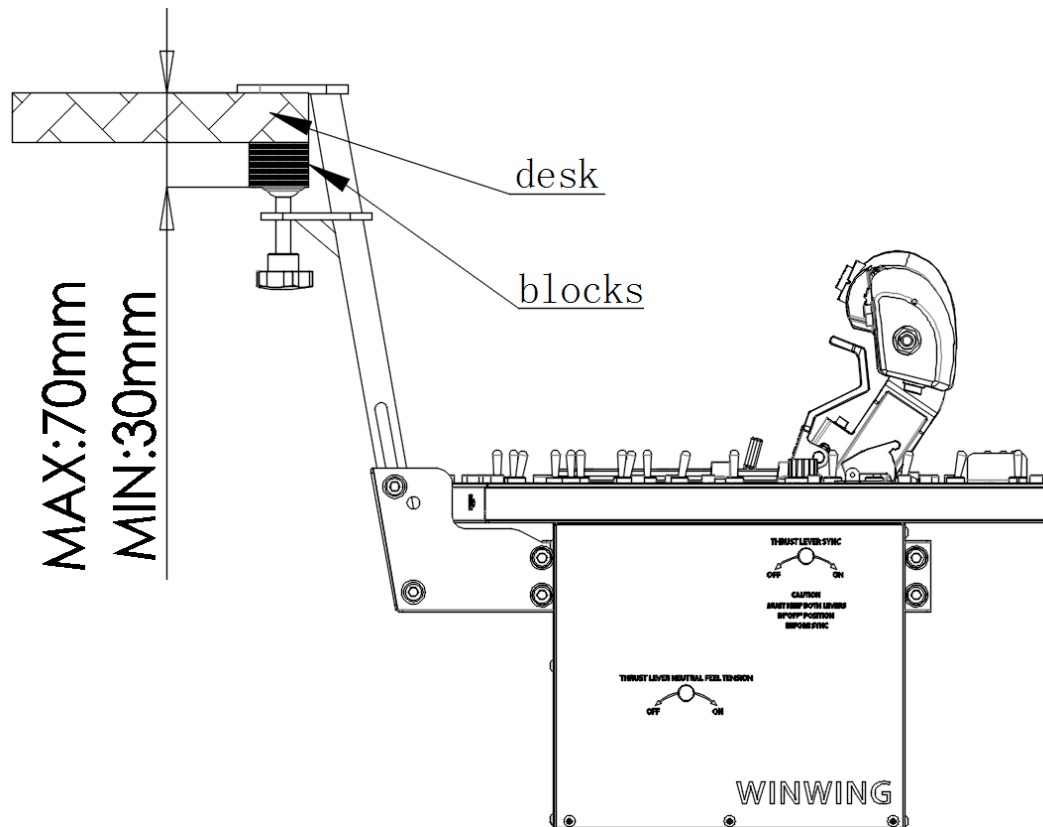

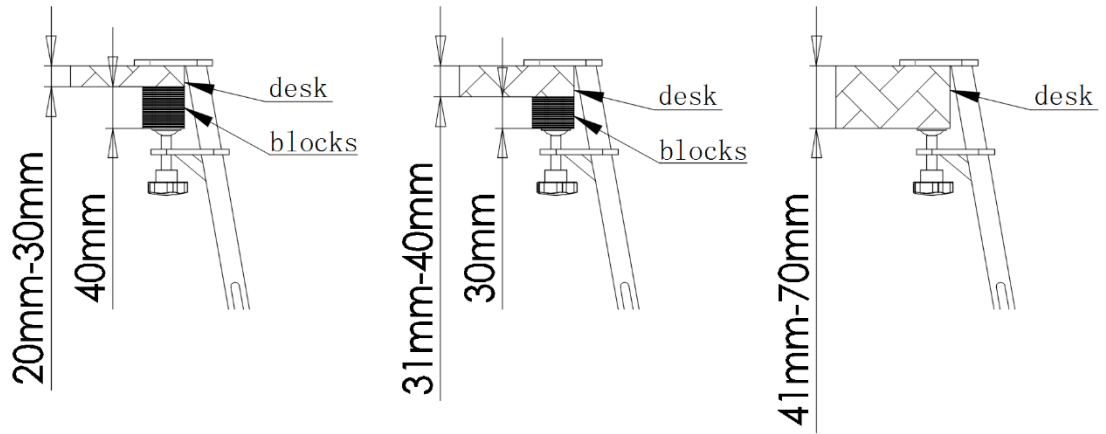

For example:

- If the thickness of table is 20mm - 30mm, it is recommended to use the thickness of the block 40mm;
- If the thickness of the table is 31mm-40mm, and it is recommended to use the thickness of the block 30mm;
- If the thickness of the table is 41mm-70mm, no need to use block.

You can change the height difference between the throttle side panel and the desktop by adjusting the desk mount holder

Minimum 209mm

Maximum 262mm

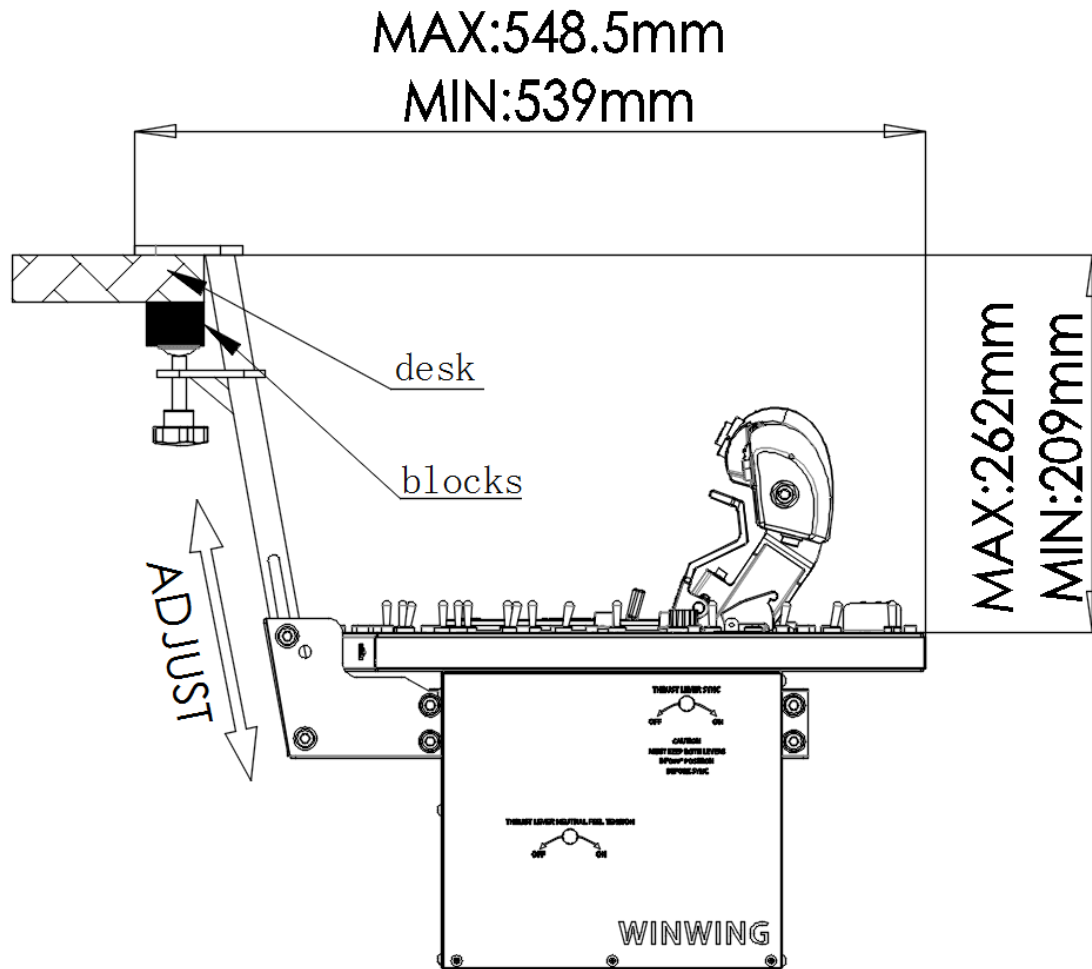

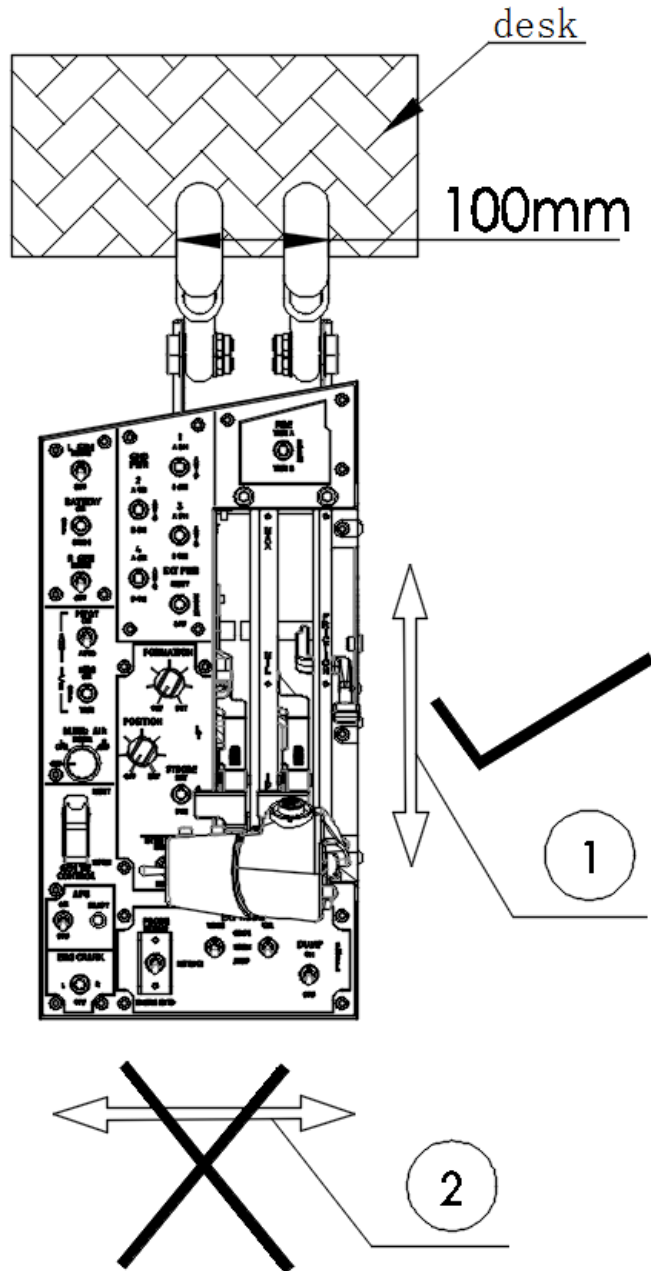

- ① Please follow the step 1 arrow to use throttle.
- ② Don' t use throttle with arrow on step 2.

5 Other installation methods (Official advice)

5.1 Gaming chair installation

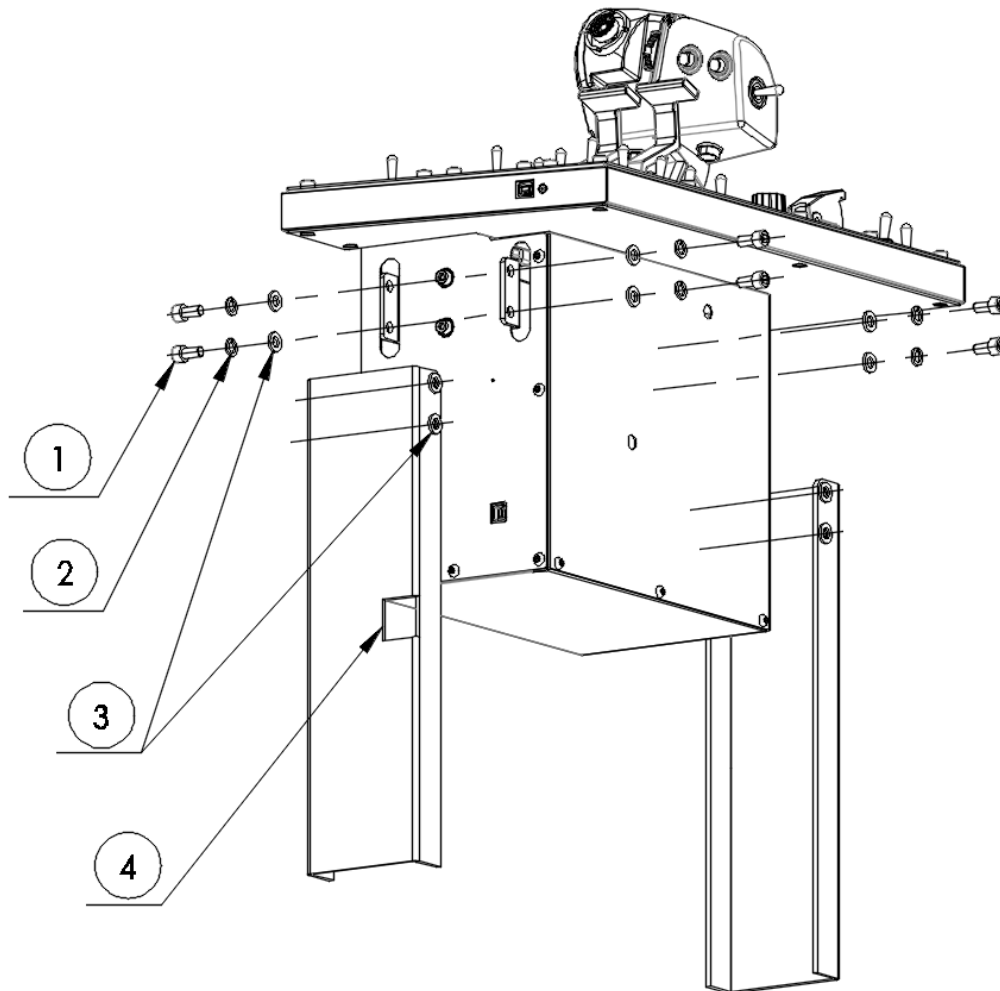

- This installation method requires your own accessories. We can only provide simple drawings.

The accessories are as follows:

- ① 8 of M6 14mm-type Allen screws
- ② 8 of M6 type Elastic screw gasket
- ③ 16 of M6 type Flat screw gasket
- ④ Avoid space for USB outlet

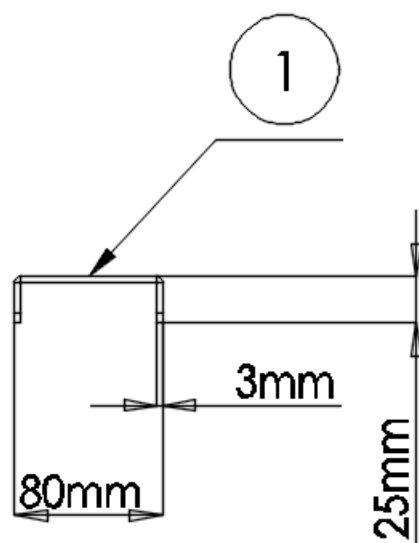
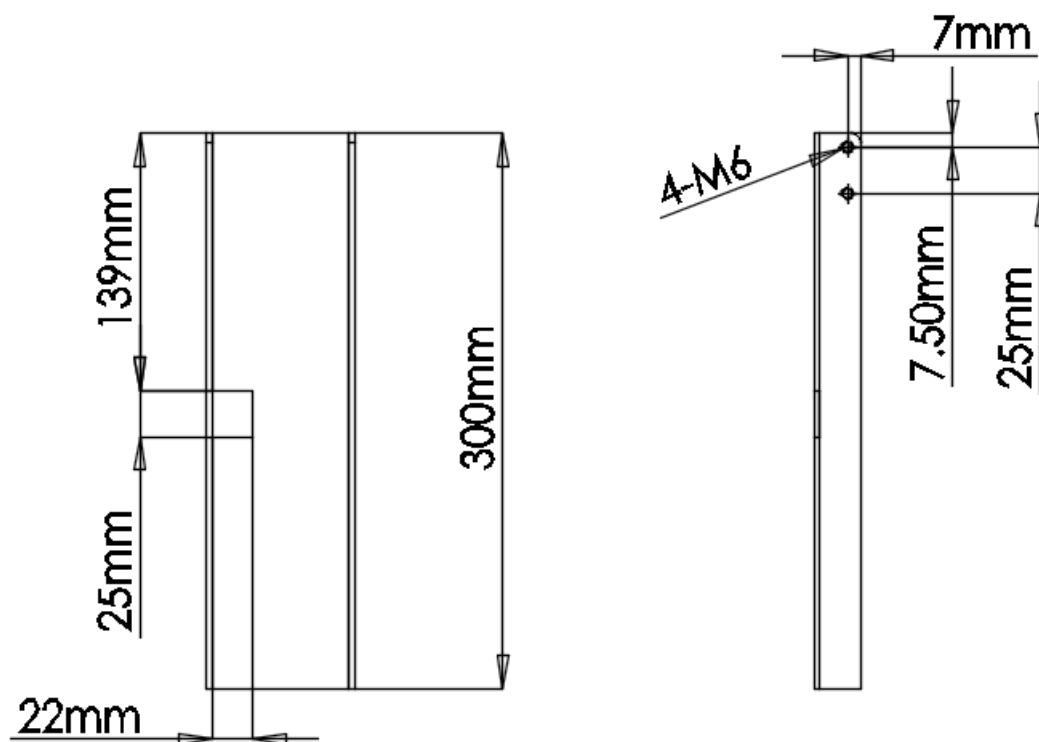

Mounting size as shown on picture.

- ① Dimensions Specifications: 80mm * 25mm sheet metal bending parts, rectangular tubes, profiles, etc.
- ② If you need Template. Click to (www.winwing.cn)

5.2 Cockpit installation

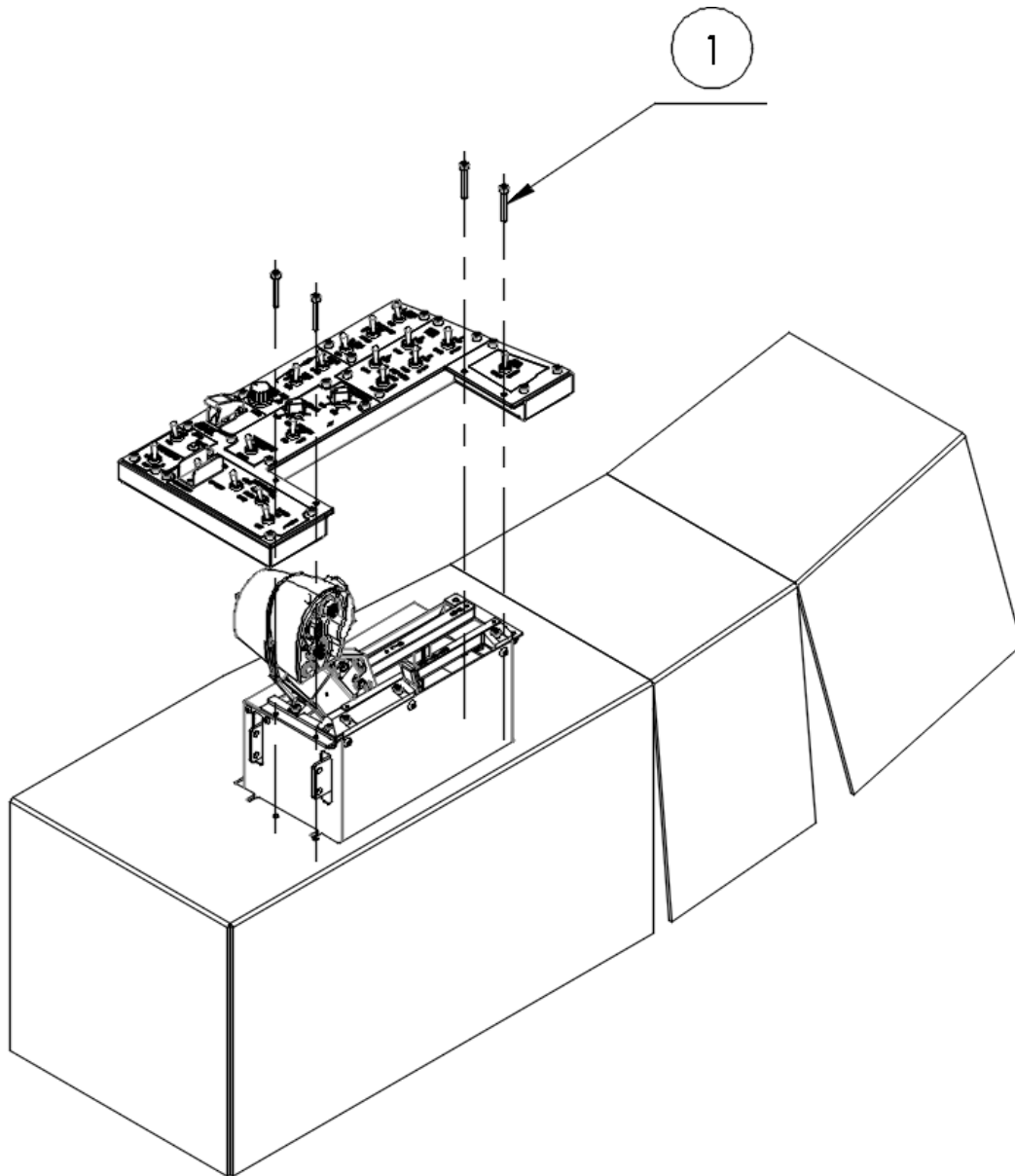

Remove the original 4 of M5 10mm-type Allen screws on the throttle side panel.

① Replace with 4 of M5 35mm-type Allen screws.

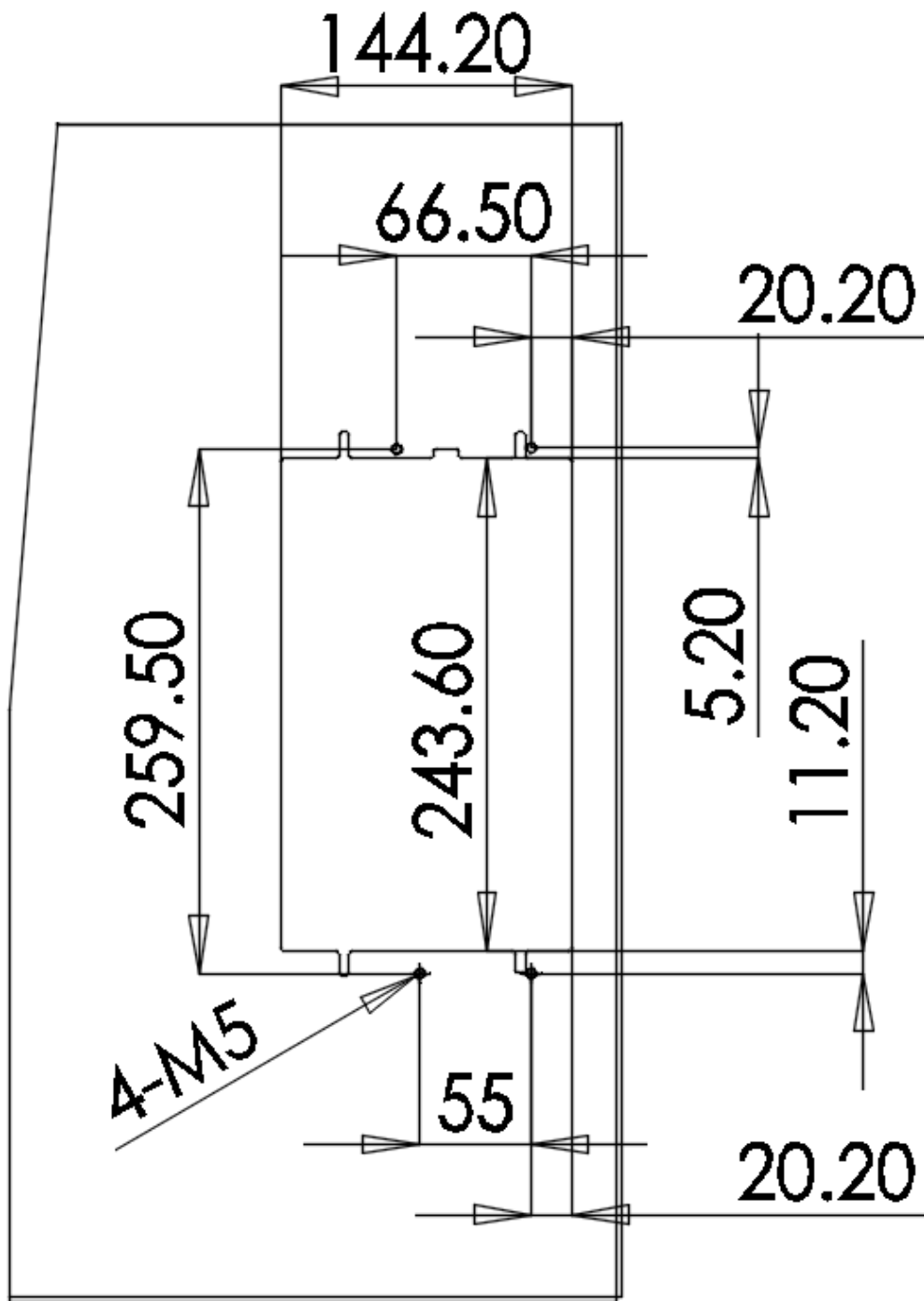

- ③ The unit in the figure is mm
- ④ Mounting size as shown on picture.
- ⑤ If you need 2D Template. Click to (www.winwing.cn) .